



THE CENTURION SMOKEBOX



"Providing smoking news and steaming interests to members and friends"

Centurion Society of Model Engineers

Kwikkie Crescent 999
Centurion Lake Ext 1 (Zwartkop)
PO Box 16023
Lyttelton, 0140



www.centuriontrains.com

csmetrains@gmail.com

<https://www.facebook.com/pages/->

[SocietyofModelEngineers/420612321335973?ref=hl](https://www.facebook.com/pages/-SocietyofModelEngineers/420612321335973?ref=hl)

GPS 25° 51.066'S 28° 10.971' E

No responsibility is taken by the CSME for any subject matter in this newsletter other than official Society notices.

CSME NEWSLETTER DECEMBER 2017

COMMITTEE

Chairman – Leon Kamffer
Vice chair. – John O'Mahony
Treasurer – Ballot Marx
Secretary – Imogene Groothuizen
Committee – Jon Shaw
Committee – Roko Popich
Safety – Norman Reyneke
Non-committee person contacts
Caretaker – Louw Myburgh
Facebook – David Shaw
Alarm system – David Gough
News letter – Jon Shaw

(082-577-7813) email: lkamffer@mweb.co.za
(082 809-3595) email: john.o@telkomsa.net
(082-808-5783) email: ballotmarx@gmail.com
(082 484 4237) email: imogenegroothuizen@gmail.com
(072 437 0710) email: jonsamshaw@gmail.com
(012-345 2592) email: popichfam@gmail.com
(082-553-7344) email: fangrj@telkomsa.net

(012 643 0750) Phone and fax
(083 326 2107) email: davidandvero@outlook.com
(078 222 0695) email: davepg@gmail.com
(012 332 0814) email: jonsamshaw@gmail.com

The editor and committee wish all members and readers a blessed Christmas and a Happy and prosperous New Year

Membership Fees 2018

2018 SUBS R300 FOR ORDINARY MEMBERS
AGM have fixed the fees at the same level until end of 2018

R200 FOR SENIORS & STUDENTS
Subs are now due for review at 2018 AGM for 2019.

Bank details for any payments to CSME.
For any payments please email details of payment to
Ballot Marx at csmetrains@gmail.com or
ballotmarx@gmail.com

Bank Details are as follows:
Bank: First National
Branch: Centurion, code 26-15-50
Account Name: Centurion Society of Model Engineers
Account No: **62060752906**
Reference: **Your Full Name/ subs 2018 (or what payment is for).**

Note the account number change in red

According to our constitution those in arrears of subs for 2017 as at 1st May 2017 have automatically and voluntarily terminated their membership, and should contact the committee if they require being re-instated.

If you are intending to drive a loco on our track you must either have subs paid up to date as at the time of driving, or be a bona fide paid up member of another model engineering society to be covered by our public liability insurance.

Members are reminded that to obtain a CSME boiler certificate, the builder must consult our boiler inspector prior to commencing any work. This is to ensure the envisaged boiler is of an acceptable design and to ensure the boiler is built to current regulations and to plan the interim stages at which inspection is required. Our inspector is Leon Kamffer.

CSME have now adopted the Pietermaritzburg boiler code which will be published on the member's page of the website. ALL members are requested to ensure that CSME have copies of the boiler certificates for **all** their locos. Copies can be scanned and sent by email to jonsamshaw@gmail.com or imogenegroothuijzen@gmail.com or alternatively, bring your certificate to either Jon Shaw or Imogene Groothuijzen on club day to be copied or scanned. We then have a record should there be any insurance or Health & safety queries.

Official correspondence and newsletter

If you are not receiving mail from the CSME you should contact the secretary or editor to update your details. Those members without email can collect a copy of the newsletter from the clubhouse on track day.

Obituary

It is with regret that I have to inform you of the recent passing of Joe Magill of the Knysna society of model engineers.

Next Club Meetings

Saturday 16th December gathering of the Brotherhood Christmas party

Next running day will be Sunday 17th December 2017.

Next committee meeting will be at the clubhouse on Saturday, 16 December 2017 at 10h00.

We will be officially closing 17th Dec and reopen 7th Jan 2018

CSME, CMBC CNC & YACHTS Christmas Party.

All are welcome

The club Christmas party will be held on **Saturday, 16th December**. Bring your own meat and the club will provide the salads, bread rolls, ice cream and fires.

Roko's Piece.

Hi Gang, I have been able to get a few tools sponsored for our party, we will include them with our trophies and thank you gifts, I have a schedule for the day of 16th December.

Saturday 16 December will be CLOSED TO PUBLIC, only open to members, family and friends of members (to make up numbers for father Christmas , not like last year only 3 children) people must respond how many will come so Liz can buy sweets and juice for children. 12h00 ; father Christmas, 13h00 ; club prize giving, 14h00; club braai , bring own meat and drinks, **will the ladies please bring one salad each to be shared with members,** CHEERS ROKO

Track and grounds

Recently we have had some quite heavy rain at the track with some flooding but not high enough to cause any problems.

Monday and Saturday Gangs

Dennis is in full service and Barry has now been completed so is back in service. Trompie problems have been diagnosed and fixed so that loco is up and running.

There has been some preliminary work done on the planned 3 electric locos ready for a serious push forward by any members interested to help during the week 11th to 15th December. contact Leon Kamffer. lkamffer@mweb.co.za or 08257777813

Secretary/librarian's titbit

For a change I have nothing to moan about! I think all will agree that we have had a very good year and on that high note, I wish all members and their families a well-deserved, peaceful festive season and best of health for 2018. Hoping that Father Christmas will be bringing special presents for Paul Fisher, Geoff Bailey and David Shaw in celebration of their birthdays.

Imogene Groothuijzen



The Loco and riding car linking systems are being overhauled and link height being standardised so if any member is available to assist during the week 11th to 15th December contact Leon Kamffer. lkamffer@mweb.co.za or 08257777813

New couplers were designed to replace and standardize the society's rolling stock. With the additional passenger trucks obtained there were quite a few different coupler heights in use, and some had problems with the space behind the pin. A lot of the clubs coupler links are worn as well.

The new design was upgraded to 10mm to be in line with the international practice for 71/4" rolling stock. The height was selected as 150mm or 6 inches that is the standard for larger scale locomotives.

The club has profiled a set of new couplers as well as links. A few special links were also cut that have smaller holes to cater for members that have different size pins on their riding cars.



New coupling links for finishing.



New couplings for rolling stock

Pietermaritzburg model stationary engines

A few more are now available on track day. Contact Jon Shaw if you wish to purchase either kits or conversion kits. The prices are inclusive of courier delivery charges.

Model A & B are R311.55 each and the conversion kits are R130.85 each.

On Saturday 18th November 5 members turned up for help and Leon's larger machines with digital readouts were put into service to run a production line a la Henry Ford with all of us doing some work to progress. Apart from setting up the machines to drill holes etc. and running them, there was thread tapping, finisher sanding, acid cleaning and other odd operations to be done, so everyone had something to do. At lunchtime we had a wors braai. The committee meeting was held in the afternoon. Leon will be arranging a further session in due course.



Drilling the parts for PMB engines.



Tapping the holes.

Commercials

Use this newsletter to advertise your for sale and wanted (wish list) items.

If the editor is not informed as to when to delete adverts, these will be removed at the editor's discretion

Hugh (Bill) Williams is looking for a small milling machine to make components for his models. Contact him by email bill2hugh@gmail.com or Cell 0823380360.

Wheels required

A modeller needs a pattern or castings for 160mm wheels for a 5" gauge British loco. If someone has a pattern to borrow or wheels to sell please contact Leon Kamffer on lkamffer@mweb.co.za or 0825777813.

Wanted Jon Shaw still needs a workshop manual for a 2005 Opel Corsa 1.7DTI Bakkie to either buy or loan for a few days. Haynes manual number 5577 is the nearest to my requirement unless you have genuine Opel documentation.

jonsamshaw@gmail.com or phone 0123320814 cell 0724370710.

Now the fun bits

While stitching a cut on the hand of a 75 year old farmer, whose hand was caught in the squeeze gate while working cattle, the doctor struck up a conversation with the old man.

Eventually the topic got around to politicians and their role as our leaders.

The old farmer said, "Well, as I see it, most politicians are 'Post Turtles'."

Not being familiar with the term, the doctor asked him what a 'post turtle' was.

The old rancher said, "When you're driving down a country road and you come across a fence post with a turtle balanced on top, that's a post turtle."

The old farmer saw the puzzled look on the doctor's face so he continued to explain. "You know he didn't get up there by himself, he doesn't belong up there, he doesn't know what to do while he's up there, he's elevated beyond his ability to function, and you just wonder what kind of dumb arse put him up there to begin with."

Best explanation of a politician I've ever heard

On a bulletin board:

Success Is Relative.

The more The Success,

The more The Relatives.

Behind Every Great Man,

There Is A Surprised Woman.

Getting Caught

Is The Mother Of Invention.

Stop press : The new coupler

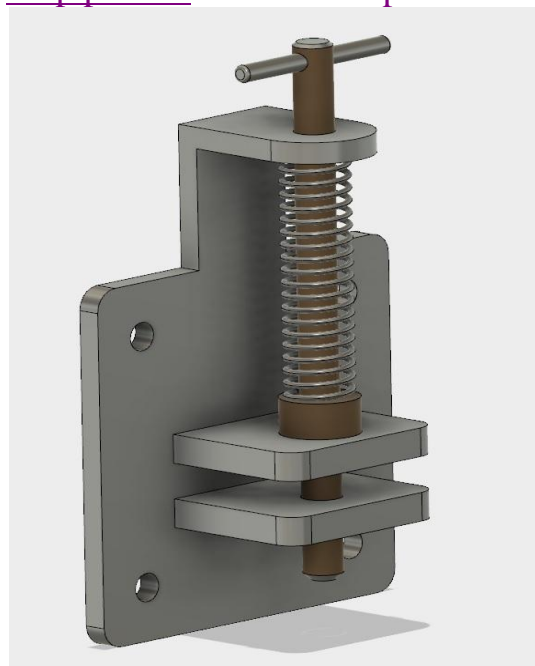

Ad. In Hospital Waiting Room:
Smoking Helps You Lose Weight....
One Lung At A Time!